

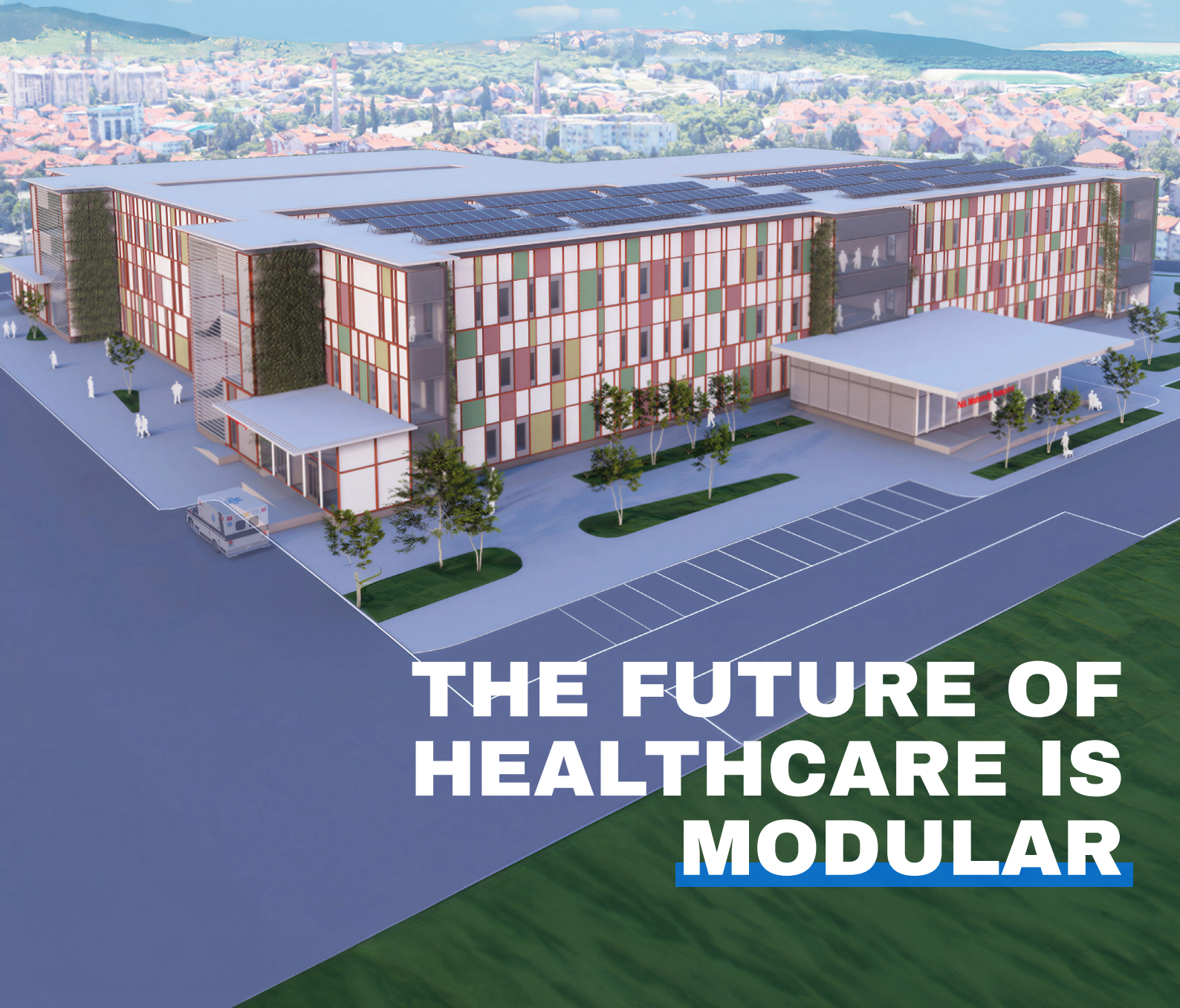

2026

CONCEPT PAPER

LAND-BASED HOSPITALS



**THE FUTURE OF
HEALTHCARE IS
MODULAR**

VAMED+WWH

VAMED+WWH is a global healthcare company that provides flexible and sustainable modular hospital solutions at the highest medical standard worldwide.

We partner with governments, international organizations, NGOs, private charities, foundations, and other key stakeholders to make quality healthcare universally accessible.

We aspire to a world where **barriers of geographic location, infrastructure, capacity, and response time no longer mean obstacles to accessing quality healthcare for every person, family, and community.**

UNDERSTANDING THE SCALE OF TODAY'S CHALLENGE

Across Guyana's healthcare system, demand continues to outpace available capacity. A population of approximately 840,000 is served by a single major public hospital, with specialist services concentrated almost entirely in Georgetown. An **estimated 12.5% of the population has no access to any form of healthcare** – with rural and hinterland communities, representing roughly 90% of the country's landmass, bearing the greatest burden.

Today, non-communicable diseases are the leading cause of death at **822 per 100,000 annually**, with Guyana carrying the **highest cardiovascular mortality rate in the Americas**. Behind these figures are patients who cannot reach specialists, communities without diagnostics, and a system under sustained, structural strain.

At the same time, the workforce underpinning this system is critically stretched. With just **1.4 physicians per 1,000 people** and acute shortages in obstetrics, anaesthesia, and emergency care, district hospitals routinely cannot manage complex cases.

Financial investment is accelerating, with Guyana's **2025 health budget of GYD \$143.2 billion** – the largest ever allocated – signalling clear political commitment to reform. Yet structural gaps in infrastructure, workforce, and access remain significant. These are well-understood challenges, and their scale points directly to the need for scalable, practical solutions that can be deployed quickly and reach the communities that need them most.

OUR COMMITMENT

Two major hospital projects are already underway in Guyana – and VAMED+WWH is here to see them through. Since acquiring VAMED Engineering in April 2025, WWH has re-engaged directly with the Government of Guyana. These projects represent the single largest investment in Guyana's health sector, and completing them is our first commitment to the Guyanese people.

- **Guyana Paediatric and Maternal Hospital, Ogle** – Guyana's first dedicated facility for mothers and children. 256 beds, 24,000 m², with full A&E, surgery, obstetrics, imaging, dialysis, and oncology services.

- **New Amsterdam Hospital Campus, Berbice** – 230 beds, 24,000 m², bringing specialist care, surgical theatres, mental health services, and clinical training to Region Six – ending the need for patients to travel hours to Georgetown.

Beyond these two facilities, WWH brings a fundamentally modern approach to healthcare infrastructure – fully equipped **medical modules**, manufactured in Europe to the highest clinical standards and deployed as ready-to-use units. Faster than traditional construction. Scalable across regions. Built for the communities permanent infrastructure alone cannot reach. **Because the future of healthcare is modular.**

COMMITMENT



PORTFOLIO

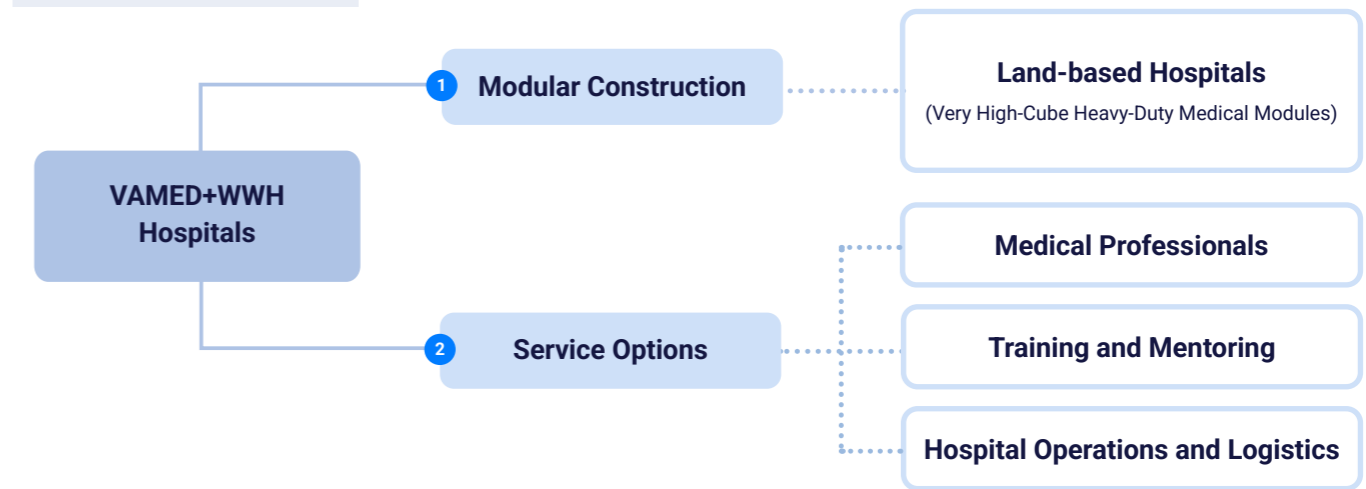

Our solutions include: **1. Modular construction of Land-based Hospitals**, anywhere in the world constructed using the proprietary **Very High-Cube Heavy-Duty (VHCHD) Medical Modules as building blocks**.

We offer **2. Execution and management of the complete hospital operations**, including a broad range of services from logistics and coordination to medical and technical training, all supported by additional specialized services.

PROCESS



01. VHCHD MEDICAL MODULES



3D Rendering of an Equipped 30 m² / 300 ft² Very High-Cube Heavy Duty (VHCHD) Medical Module

Built for temporary or long-term use, offering versatile solutions, that provide flexibility and reliability.

MEASUREMENTS

Our **Medical Modules** are designed around three main parts, each playing a key role in creating a safe, functional, and efficient healthcare environment.

The **Technical Area** contains all the necessary cables, tubes, and systems, arranged in a way that makes maintenance, monitoring, and upgrades straightforward. This ensures that medical and electrical infrastructures work together smoothly, minimizing risks and keeping operations reliable.

The **Hospital Room** is the main usable space, carefully planned to provide comfort, accessibility, and an efficient workflow for both patients and staff. Every aspect, from the layout to the placement of equipment, is designed to make the experience better for patients while helping healthcare professionals work safely and effectively.

Finally, the **Ground Module** serves as the base of the unit, giving it stability, strength, and protection.

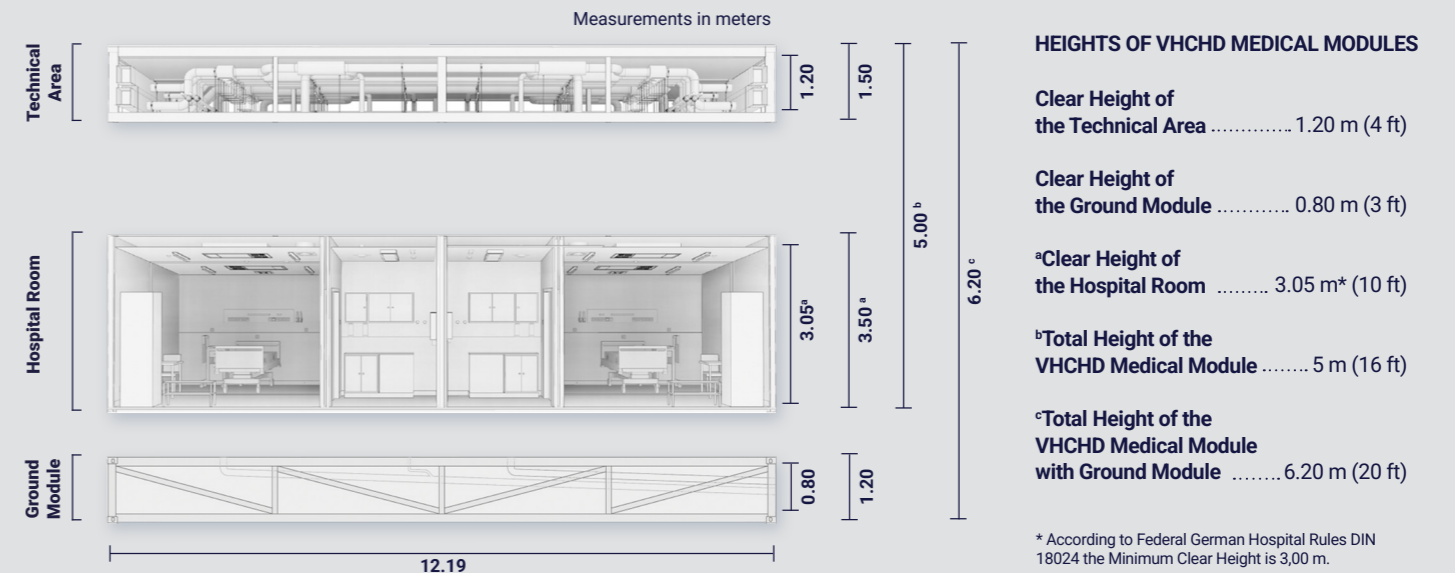

3D Rendering of Very High-Cube Heavy-Duty (VHCHD) Medical Modules

> Fast Delivery 24/7

Transportable via trucks, railway, ships and other standard shipping channels; VHCHD Medical Modules are ready to deploy anywhere in the world.

> Fully-Equipped

Each module comes with compliant ventilation and cooling systems and can be outfitted with advanced medical technologies, including X-ray, ultrasound, and CT scanners.

> Longevity

Designed with a 30-year anti-corrosion warranty, ensuring long-term healthcare solutions and minimizing the need for frequent replacements.

> Adaptability

Engineered to accommodate future changes, allowing reconfiguration or expansion while reducing reconstruction and waste.

VAMED+WWH modular hospital solutions are constructed using our proprietary **VHCHD Medical Modules**, precision-engineered building blocks for modern healthcare facilities.

They are manufactured in our European factories, ensuring **high-quality, consistent construction**.

This factory-controlled process supports **structural safety, precise installation of mechanical and electrical systems, and integrated infection-control features**, creating a modern, spacious, and comfortable hospital environment.



Mini Hospital - Seville

ISO CERTIFICATIONS

Our factory is certified under international ISO norms, forming an **Integrated Management System** that reflects our commitment to excellence, sustainability, and the highest operational standards.

- **ISO 9001:2015 – Quality Management**
Ensures consistent, high-quality products and services, builds customer confidence, and can unlock new markets.

- **ISO 14001:2015 – Environmental Management**
Demonstrates environmental commitment, reduces legal risk, enhances public image, and enables access to international markets and environmental incentives.

- **ISO 45001:2018 – Occupational Health & Safety**
Enhances workplace safety, supports preventive risk assessment, lowers insurance costs, and ensures legal compliance.

VERSATILITY

The **VHCHD Medical Modules** serve as foundational units to configure all hospital rooms, seamlessly configuring **15 specialized medical departments**, from aseptic **operating to negative-pressure isolation rooms to dialysis, pharmacy and diagnostics**, as well as **5 support departments** for hospitals of all scales and sizes.

Leveraging over **40 years of medical expertise**, we optimize hospital workflows through **strategic spatial design**, ensuring efficient patient access and enhanced operational performance.

Each area is positioned to **reduce cross-traffic and streamline processes**, allowing healthcare teams to collaborate effectively and **respond quickly** to changing needs. Modular configurations add another layer of adaptability, enabling **rapid reorganization for emergencies, seasonal surges, or specialized treatments without disrupting core operations**.



Outpatient Clinic Configuration using Very High-Cube Heavy-Duty (VHCHD) Medical Modules

The innovative design of our VHCHD Medical Modules enables healthcare delivery at the highest medical standard

VHCHD Medical Modules can be easily transported and rapidly installed to create fully operational land-based hospitals wherever they are most needed.



Modular Advanced Tech

Each module is designed for adaptability and resilience. Modules are engineered to **withstand diverse climate conditions while remaining fully customizable** to meet client-specific requirements.

Optional integrations include **solar energy** systems, eco-friendly structural platforms, **rainwater harvesting**, **ballistic protection**, and state-of-the-art **germicidal UV-C or FAR UV-C lamps** for superior airborne infection control.

02. LAND-BASED HOSPITALS

Land-based Hospitals are constructed with **VHCHD Medical Modules** to rapidly assemble a fully-functional facility.



Land-based Hospital Example

> Rapid Deployment

Rapid construction suitable for emergency situations. Set up of an **operational Clinic with 2.850 m²/30k ft² of hospital space** (108 VHCHD Medical Modules) **can be completed in 10 days**.

> Add-ons

Optional to include **autonomous operations**, such as water treatment, diesel-based energy production and incinerators, based on European norms.

> Versatility

Adaptable in size, easy **reconfiguration of medical departments** and swiftly relocatable after initial purpose, fit for both short and long-term use.

> Sustainable

Zero cement construction, **low CO₂ emissions** and barrier-free.

Additional features to suit all climate conditions and adapt to our client's needs.



Earthquake resistant

Our hospitals are built with advanced structural reinforcements to ensure maximum safety during seismic activity.



Sandstorm resistant

Our buildings are designed specially with entrance locks preventing sand and dust intrusion.

ADAPTABLE

VAMED+WWH Land-based Hospitals can easily **expand** vertically **up to 6 levels** and horizontally on **all 4 sides**. They can either expand existing hospital services or function as fully independent healthcare facilities.

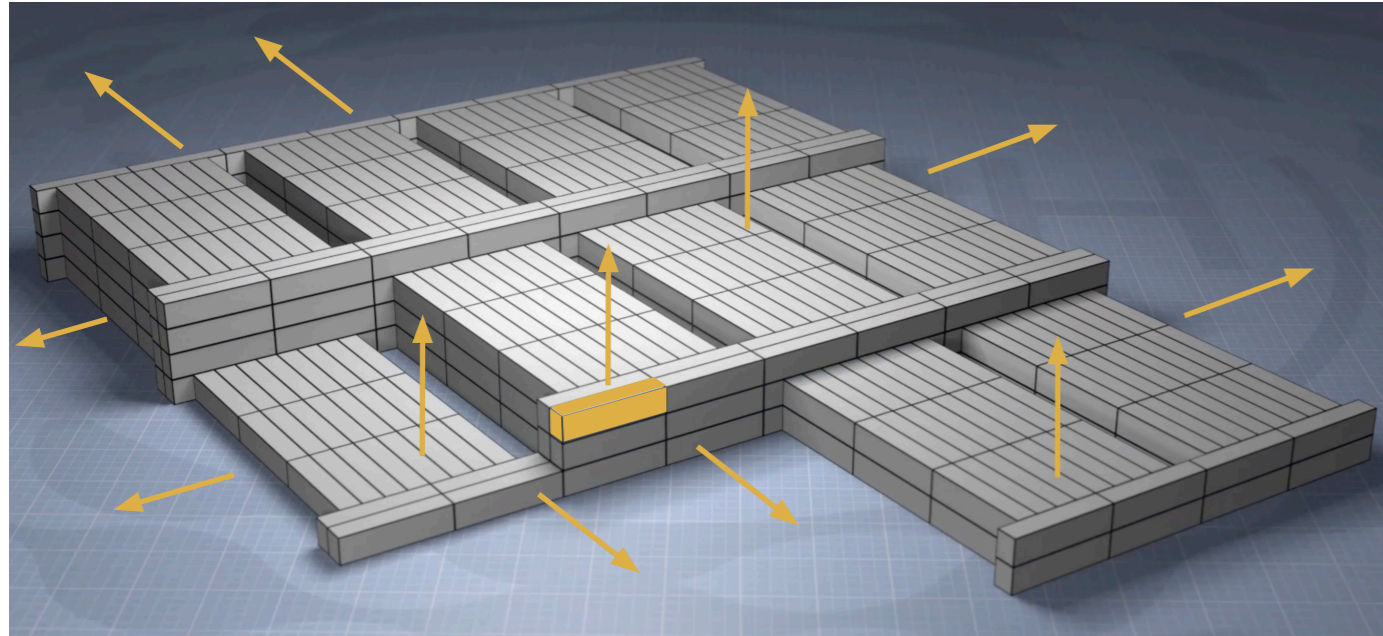

Flexible Expansion Options from a Small Clinic of 165 m² (1,726 ft²) up to Maximum Hospital with 95,970 m² (1,033,012 ft²)



Spacious Circulation Areas



Aseptic Operating Room



Our **Click & Connect System** allows multiple hospital configurations.

With our **Click & Connect System**, **VHCHD Medical Modules** effortlessly link together and expand in any direction and up to 6 levels. This modular flexibility allows hospitals to grow, adapt, and reconfigure dynamically, turning complex infrastructure challenges into elegantly engineered solutions.

FLEXIBLE SIZES

VAMED+WWH Land-based Hospitals offer a wide range of hospital configurations specifically tailored to suit the unique requirements of each mission, ensuring versatility in size to address a variety of needs.

From small local **Outpatient Clinics** providing quality healthcare on demand, to **Medium Sized Hospitals** that offer surgical procedures and generous hospital space for inpatient care, or to advanced **Multi-story Main Hospitals** with up to **6 floors**, covering all healthcare needs.



Example of a local Land-based 260 m² (2,798 ft²). Outpatient Clinic. Optimized for primary care.



Example of a 3-Story Medium sized Land-based Hospital of 5,481 m² (58,996 ft²). Featuring surgical suites and inpatient wards.



Example of a Land-based 4-Floors Main Hospital of up to 82,000 m² (882,640 ft²). Designed for comprehensive specialist care.

Our Modular Hospitals Pre-configurations

We fully customize hospital solutions tailored to each client's specific needs. To streamline the planning process, we also offer four preconfigured hospital models: **Basic**, **Medium**, **Large**, and **XXXL**.

These modular designs can either complement existing hospital infrastructure or be rapidly deployed in any large space adapted as temporary wards with patient cots.

Monthly Estimation of Patient Volume

BASIC



OUTPATIENT VISITS:
3,000–7,000 visits/month*

MEDIUM



OUTPATIENT VISITS:
3,000–7,000 visits/month*

LARGE



OUTPATIENT VISITS:
6,000–14,000 visits/month*

XXXL



OUTPATIENT VISITS:
16,000–32,000 visits/month*

*A range of outpatient visits was estimated based on the two scenarios above (8 hours a day, 5 days a week and 12 hours a day, 7 days a week) with each physician seeing three patients per hour.

03. SERVICE OPTIONS

VAMED+WWH offers versatile support options tailored to each project's needs, allowing clients to choose their desired level of assistance. From **consultation** or **training** up to **full-service hospital operations**, VAMED+WWH staff bring years of international hospital management experience to the table. Our support level can often gradually decrease over time as the client builds their own local workforce and capacity.



Hospital Management

Facility and Equipment Maintenance

VAMED+WWH biomedical and facility engineers can manage your equipment service contracts, with optional extended warranties for long-term support.

Sourcing of Medical Staff, Doctors, Nurses, Technicians

Access thousands of qualified medical professionals worldwide through VAMED+WWH for comprehensive direct patient care. Our experienced staff thrives in diverse specialties and challenging environments.

IT Support Hardware and Software

General and targeted staff training, capacity building for local partners, project and operations consulting, and healthcare system design.

Staff Training Online, Locally and Abroad

Strengthen your staff with specialized training, covering CPR certification, advanced life support, patient-centered care, and a range of essential skills. Your staff can be trained online, locally or receive special training at one of our Headquarters (Spain, Germany and Serbia).

04. MAIN LOCATIONS

- 1 **Corporate Headquarters** in Switzerland
- 2 **Headquarters North** in Hamburg, Germany
Functions as the Administrative Center.
- 3 **Headquarters South** in Belgrade, Serbia
24/7 dispatch center for worldwide missions and also our training center to prepare our specialists for all settings and missions.
- 4 **Innovation Center and Factory** in Seville, Spain
Here we explore technologies designed to easily adapt to the specific needs of each project. It produces **30,000 m²/330,000 ft²** aseptic hospital space per year.
- 5 **Manufacturing Factory** in Pancevo, Serbia
Producing yearly up to **230,000 m²/2.5 million ft²** aseptic hospital space. In this facility our Modules will be fully equipped and ready for use.
- 6 **Engineering Hub** in Riga, Latvia
Designed to be the central point of expertise on advanced healthcare solutions, construction, and modular production, using **Building Information Modeling (BIM), Artificial Intelligence (AI) tools**, and **parametric modeling** in our design process.
- 7 **Headquarters Austria** in Vienna, Austria
In 2025, WWH acquired VAMED Engineering's international project business, expanding its global operations and capabilities.





vamedwwh.com
wwh.com

Headquarters North

Address

Sportallee 1, 22335
Hamburg, Germany

Email

wwh@wwh.com

Headquarters Austria

Address

Brehmstraße 12, 1110
Vienna, Austria

Email

vamed@vamedwwh.com